

Pirani/Bayard-Alpert transmitters PBR (5 · 10⁻¹⁰ - 1000 hPa)

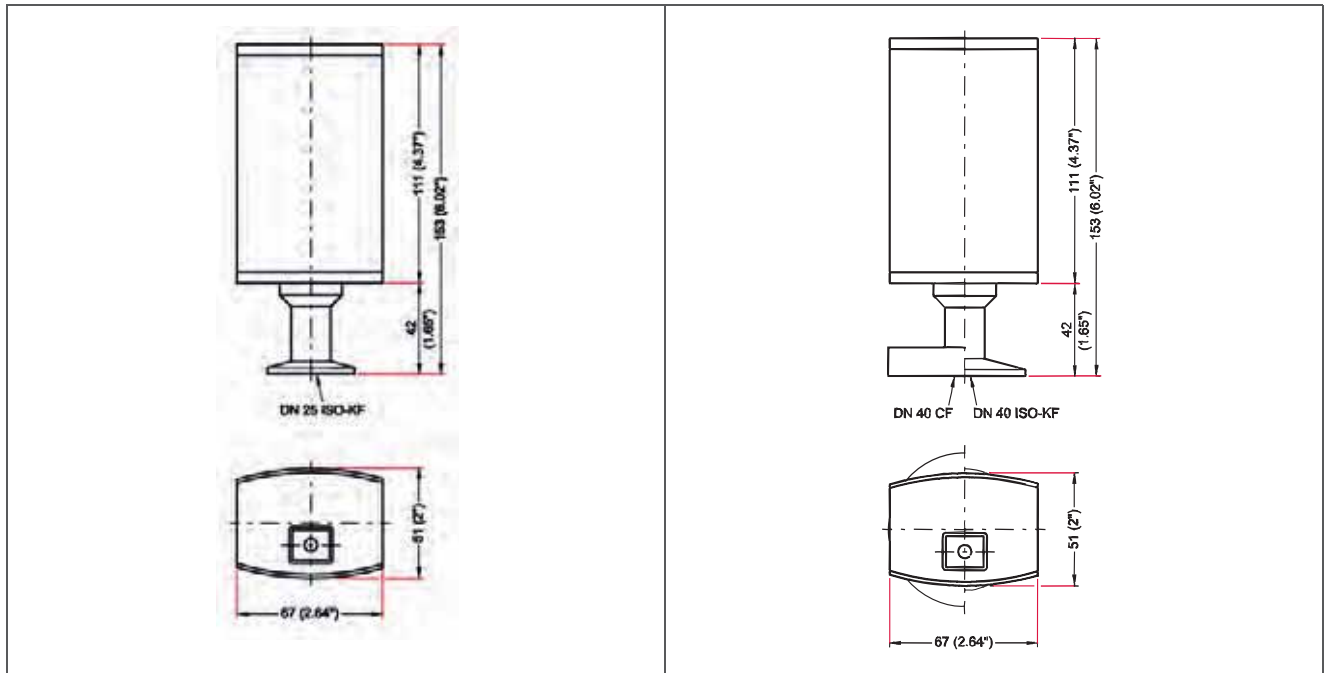

- Measurement range from 5 · 10⁻¹⁰ to 1000 hPa
- Two gauge heads (Pirani and BA hot cathode) in a single case
- Bayard-Alpert sensor ON/OFF automatically controlled by Pirani sensor
- Highly accurate
- A single flange from atmosphere to UHV
- Corrosion-resistant
- Maximum pressure refers to inert gases and temperatures of less than 55 °C

Dimensions (in mm)



PBR 260, DN 25 ISO-KF

PBR 260, DN 40 CF-R

Technical data	PBR 260, Pirani/Bayard- Alpert, DN 25 ISO-KF	PBR 260, Pirani/Bayard- Alpert, DN 40 ISO-KF	PBR 260, Pirani/Bayard- Alpert, DN 40 CF-R
Flange (in)	DN 25 ISO-KF	DN 40 ISO-KF	DN 40 CF-R
Output signal: Sensor error below	0.5 V	0.5 V	0.5 V
Output signal: Pressure range	0.774 - 10 V	0.774 - 10 V	0.774 - 10 V
Output signal: Minimum load	10 kΩ	10 kΩ	10 kΩ
Bakeout temperature	150 °C, electronic removed	150 °C, electronic removed	150 °C, electronic removed
Pressure max.	200 kPa	200 kPa	200 kPa
Flange	Stainless steel	Stainless steel	Stainless steel
Accuracy: 10^{-8} - 10^{-2} hPa	15 % reading	15 % reading	15 % reading
Weight	285 g	315 g	550 g
Filament	Tungsten	Tungsten	Tungsten
Filament	Iridium yttriated	Iridium yttriated	Iridium yttriated
Materials in contact with media	Cu, W, glass, NiFe, Mo, Stainless Steel, NiCr	Cu, W, glass, NiFe, Mo, Stainless steel, NiCr	Cu, W, glass, NiFe, Mo, Stainless steel, NiCr
Measurement range max.	1000 hPa	1000 hPa	1000 hPa
Measurement range min.	$5 \cdot 10^{-10}$ hPa	$5 \cdot 10^{-10}$ hPa	$5 \cdot 10^{-10}$ hPa
Sensor cable length	100 m	100 m	100 m
Temperature: Operating	0-50 °C	0-50 °C	0-50 °C
Temperature: Storage	-20-+70 °C	-20-+70 °C	-20-+70 °C
Supply: Voltage	20-28 V DC	20-28 V DC	20-28 V DC
Supply: Power consumption max.	16 W	16 W	16 W
Volume	24 cm ³	24 cm ³	25 cm ³
Repeatability: 10^{-8} - 10^{-2} hPa	5 % reading	5 % reading	5 % reading

Order number			
Pirani/Bayard-Alpert Gauge PBR 260, ($5 \cdot 10^{-10}$ - 1000 hPa)	PT R27 000	PT R27 001	PT R27 002

Accessories			
Sensor cable, 3 m	PT 448 250 -T	PT 448 250 -T	PT 448 250 -T
Mating connector	B 4707 283 MA	B 4707 283 MA	B 4707 283 MA